

# Local Research

As well as hosting a number of global research projects The Open University is also committed to local research projects. Below are two examples showing how The Open University is helping develop and benefit the local community.



- The Open University are currently partners in a £1.1m project to help local school students learn the skills of modern science. The aim is for students to understand themselves and the world in which they live, through a scientific process of gathering and assessing evidence, conducting experiments and engaging in informed debate. The Open University has been working closely with Oakgrove secondary school in MK. Together with teachers, we have developed a tool kit that can be used in the classroom, on fieldtrips and at home by GCSE geography students to investigate urban heat islands in MK and Northampton. Also, the tool kit has been used by year 8 students to carry out investigations into microclimates in Oakgrove school grounds.



First recycling vehicle



Recycling boxes

- In June 1990 Milton Keynes Council launched a pilot household recycling collection scheme which rapidly grew to cover the whole borough. The Open University's Integrated Waste Systems group carried out evaluation research for MKC on how well people understood what to do to participate and how effective the scheme was at capturing the recyclable materials.

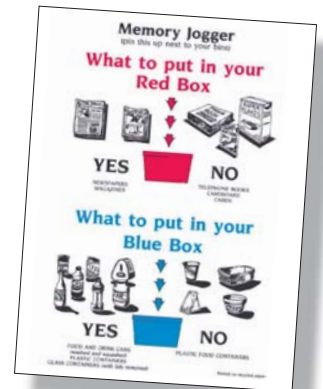

Original recycling leaflet

